

1. Product appearance

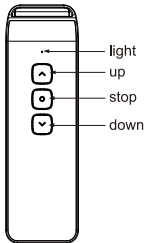

WSXE 1101
single-channel

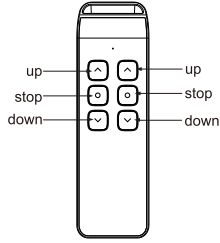

WSXE 1102
double-channels

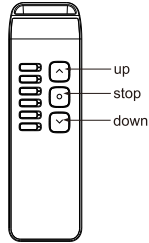

WSXE 1105
five-channels

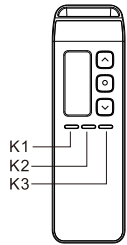

WSXE 1103
Sixteen-channels

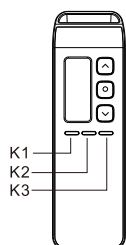

WSXE 1103-4T
Four channels with timer

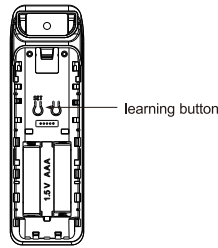

learning button

2. Technical data

Power: 3V Model: CR2032 Currency: ≤16mA
 Work temperature: -20°C to +60°C (non non LCD emitter) Code: rolling code
 Work temperature: -10°C to +60°C (LCD emitter) Frequency: 433.92MHz

3. Code learning

01. Single channel

- Short press set button one time on the motor;
- Short press learning button at back side once;
- The motor vibrate once, code learning successfully;

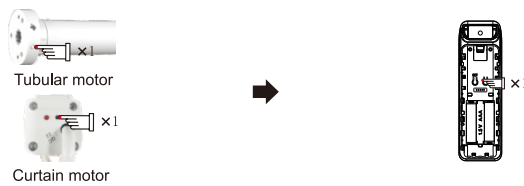

02. Double channel

- Short press set button on motor once
- Then short press one stop button to choose channel;
- Short press learning button at back side once, the motor vibrate once,code learning success

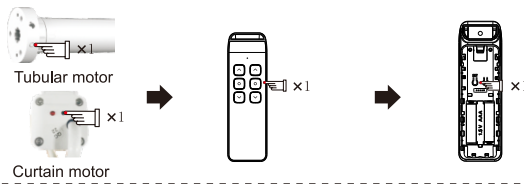

03. 6-channel

- Short press set button on motor once
- Then press channel switch button,choose a channel
- Short press learning button at back side once, the motor vibrate once,code learning success

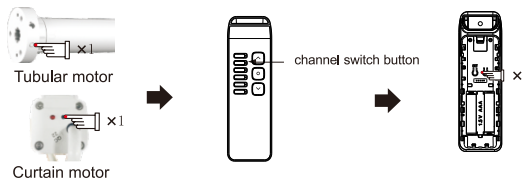

04. LCD Multi-channel (take 16-channel emitter as an example)

- Short press set button on motor once
- Then short press K3/K1 to choose one channel from 1 to 16. Then figure in the middle of the screen shows the current channel.
- Short press learning button at back side once, the motor vibrate once,code learning success

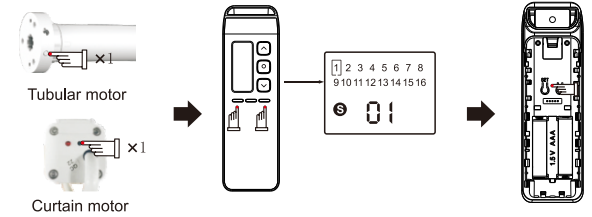

4. Single control

Press K1/K3 button to select a channel, then the corresponding motor can be controlled by the emitter through short pressing UP/STOP/DOWN button.

5. Group control(LCD emitter) Short press K2 button, then can change single control and group control

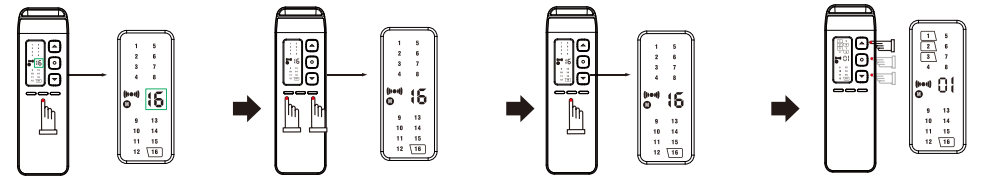

Long press K2 for 2s to enter Group Control Mode, the current channel on the upper left corner of the screen will shine.

Press K1/K3 to select one channel into group control, such as channel 16 as pic shows.

Short press K2 to confirm, same method for the other channels.

Press UP/STOP/DOWN button to exit the setting

6. Delete Group Control

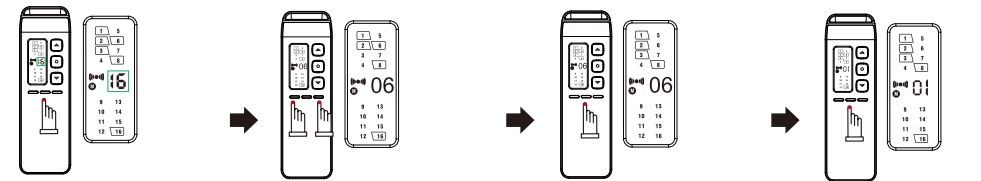

Long press K2 for 2s to enter Group Control Mode, the current channel on the upper left corner of the screen will shine.

Press K1/K3 to select one channel out of group control, such as channel 6 as pic. shows.

Short press K2 to confirm, same method for the other channels.

Press UP/STOP/DOWN button to exit the setting

Note: whether in M or S mode, the current channel is always selected

7. Maximum channel adjustment

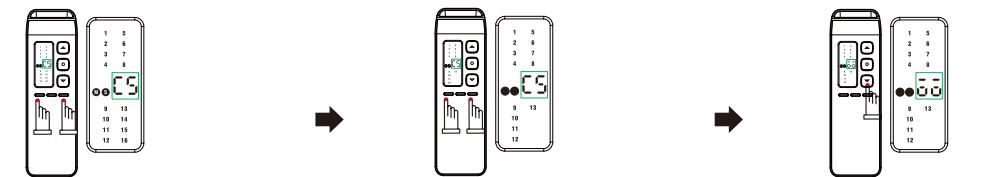

Press the K1 and K3 buttons at the same time for 3 seconds, the word "CS" will appear

Short press K1, K3 button to increase or decrease the maximum channel

Press UP/STOP/DOWN button to exit the setting, if success will show "CS" word.

8. LCD emitter timer(4-channel)

01. Time setting

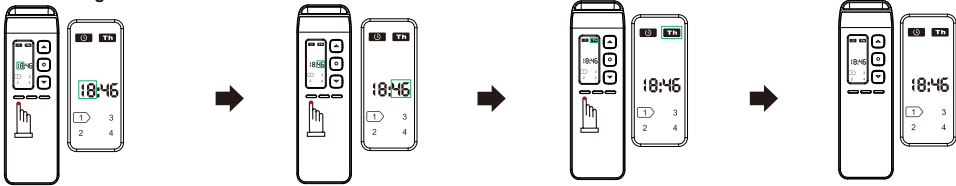

Press K1 button to enter hour setting page, now the hour figure will shine, press UP/DOWN button to adjust the hour figure.

Press K1 again to adjust minute, the minute figure will shine. Press UP/STOP/DOWN button to adjust the figure.

Press K1 again to adjust weekday, the weekday figure will shine. Press UP/STOP/DOWN button to adjust the figure.

After setting, press STOP button to exit and go back to initial page.

02. Timing setting

In the initial page, press K2 to enter timing setting page, there is a timing clock on the upper left corner. You can respectively set 8 opening time point and 8 closing time point, in total 16 point. 1-8 press K2 to cycle among 16 time point, Press K3 to choose the output channel which you want(single channel or 4 channel)

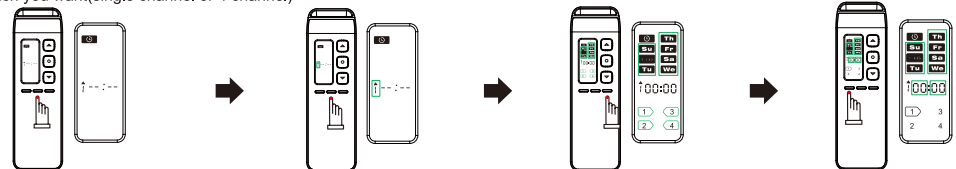

Press K2 button to enter timing setting page.

Press K2 again to select one point among 16 timing points

Press K3 to start timing setting, press K3 again to choose the channel you want (single channel or 4 channel)

Press K1 to set time(in the same way of Time setting above)

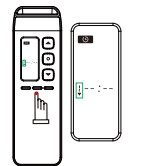

Once one time point is set, press K2 again to select other points to set time.

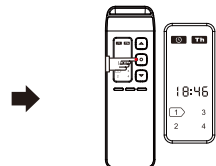

Press STOP button to exit the setting.

03. Close time function

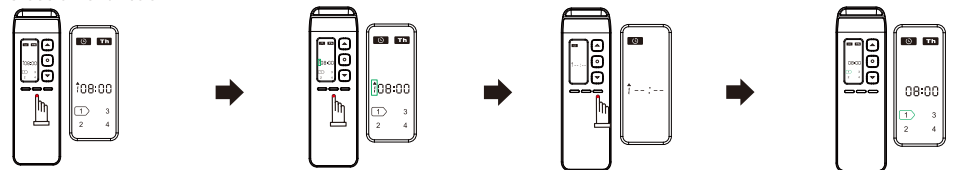

At the initial page, press K2 to enter timing setting page.

Press K2 again to select one point need to be closed.

Press K3 until above display appears, which means the point has closed; press K3 again to retrieve this point.

After setting, press STOP button to exit and go back to initial page.

04. Maximum channel adjustment

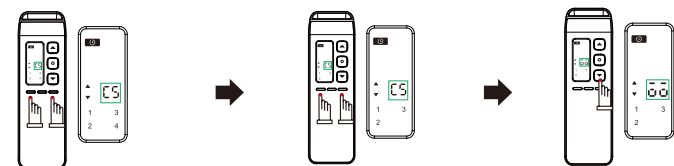

Press the K1 and K3 buttons at the same time for 3 seconds, the word "CS" will appear

Short press K1, K3 button to increase or decrease the maximum channel

Press UP/STOP/DOWN button to exit the setting, if success will show "CS" word.

05. Stopwatch function

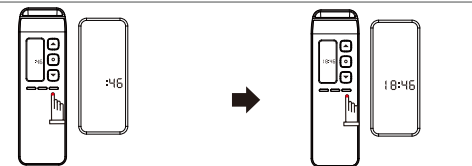

When the maximum channel is single channel, press K3 to enter stopwatch page.

Press K3 again to go back to initial page.

Note

- The emitter must enter into timing setting page if you want to set timing point(there is a timing clock on the upper left), otherwise, the setting is invalid. If there is no timing clock on the upper left, hold STOP button and press K2 within 10 seconds, then the timing clock will be there.
- You'd better not press emitter's button too long, each pressing is about 0.5s, and the pressing interval is about 1s. The emitter will stop working if the battery is in low power. Please replace the battery in this case.

9. Smart position mode(Only for WSXE1103-4T)

01. Single control mode

Note: Whether in S mode or M mode, only up and down limit is setted, smart position function is effective.

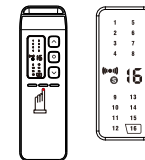

Short press K2 to single control smart position mode.

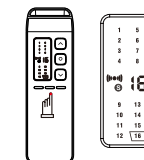

If need change channel, short press K2 to the channel you need.

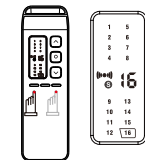

Short press K1/K3, the motor of selected channel will automatically run to the selected position.

02. Group control mode

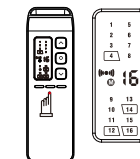

Short press K2 until in group location mode.

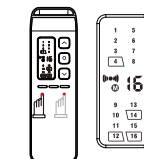

reference:6. Group control(LCD emitter) to choose channel

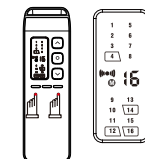

Short press K1/K3, the motor of selected channel will automatically run to the selected position.

10. Battery level reminder

For the LCD remote, when pressing the button, if the screen flashes or the display content returns to the initial state, it means that the battery power is low, and it should be replaced in time.